

**MAHARASHTRA UNIVERSITY OF HEALTH SCIENCES, NASHIK
INFRASTRUCTURE DETAILS**

Sr. No.	Particulars to be verified	Details on College Website	Adequate/ Inadequate
	College		
1	<p>Land details: Total land, owner, unitary or not, NA of all land, 7/12 extracts of all land (Applicable only to Private Colleges). (Verify land documents & Government permissions documents are uploaded on College Website. No Land/ Construction documents shall be submitted to the University. Only deficit information to be pointed out to the University).</p>	Yes	Adequate
2	<p>Total constructed area of college building</p> <p>(I) Administrative Section: Total Area 20368 sq.ft (which includes) Principal Room, P.A. Room, Receptioncue Visitors lounge, Meeting hall, Account section, Record and Central store etc.</p> <p>(II) Lecture Halls: a) Total No. of Lecture Halls 07 b) IT enabled, Audio / Video teaching Aids ----- c) Total area for lecture Halls 6300</p> <p>(III) Seminar or Conference or Examination Hall: a) Total Area 2400 .Sq.ft. b) Total Seating Capacity - 180 c) Audio / Video System and Other Facilities</p> <p>(IV) Central Library: a) Total Area : 2000 sq.ft. Total No. of Books:-2229 Distribution of books Capacity of Reading Hall :-60 for Students 60 for Teachers 7 to 8 No. of Scientific Journals 10 No. of News Papers - 05 Photo Copier Machine 02 Drinking water & Washrooms - yes b) Digital Library : No. of Computers 03 Internet Facility Yes (100kbps)</p> <p>(V) Teaching Departments: There shall be Five Teaching Departments as per MSR No. of departments 05 Departmental Area, No. of Books/ Charts / Models / Spacimens (dry and wet) / Museum in each department information to be uploaded on college website.</p> <p>(VI) Laboratories : Laboratories : As per MSR (7500 Sq.ft.) Nursing Foundation and Medical Surgical Nursing Lab (1500 Sq.ft.), CHN (900 Sq.ft.), Nutrition (900Sq.ft.), OBG and Paediatric (900Sq.ft.), Pre-Clinical Science (900Sq.ft.), Advanced Nursing Skill Lab (900Sq.ft.), Computer Lab (1500Sq.ft.), with 10 computer as per Intake capacity, AV Aids (600Sq.ft.), well Equipped Lab must have Mannequins, Articles & Beds as per MSR & INC Norms</p> <p>(VII) Auditorium:- (As per MSR)- Auditorium should be spacious enough to accommodate at least double the sanctioned/actual strength of students, so that it can be utilized for hosting functions of the college, educational conferences/ workshops, examinations etc. It should have proper stage with green room facilities. It should be well – ventilated and have proper lighting system. There should be arrangements for the use of all kinds of basic and advanced audio-visual aids.</p> <p align="center">OR</p> <p>Multipurpose Hall:-2400 College of Nursing should have multipurpose hall, if there is no auditorium.</p>	Yes	Adequate
		Yes	Adequate

	(VIII) Canteen and Kitchen Facility: [Note: Verify Canteen Facility & Hygiene is monitored as per MUHS Circular No.18/2019 dated 19/03/2019.]	Yes	Not available
	(IX) Common Rooms: Separate common rooms for boys and girls with Adequate space and sitting arrangement shall be available.	Yes	Adequate
3	University Examination Infrastructure: Strong Room for examination a) (Area- 300 sq.ft, b) Shelf, c) Steel cupboard – 1, d) CCTV, Photocopier Machine, Examination hall with benches, Parking Facility for University vehicle, Guest house facility	a) Yes b) Yes c) Yes d) Yes	NA
4	Other facilities: Waste Management, Medical Education Unit, Intercom Network, Playground, P.T Teacher or Instructor, Cafeteria, Facility for indoor games, Gymnasium / Gymkhana Facility, Is there any LMS (learning management system software) available	Yes	Adequate
5	Hostel facility: Boys (UG & PG), Girls (UG & PG), Interns, Residents, Warden/ Rector, Hygiene, Vending Machine etc.	Yes	Adequate

Hospital

6	Hospital Details	Details on College Website	
	1) Name of the Hospital : High Tech Superspeciality Bonde Hospital Amravati	Yes	
	Address: Rajapeth, Amravati - 444605, Near Nanada Market		
	Telephone No. : 07212676416		
	Bed Strength : 100 Beds		
	Distance of Hospital from the College to which it is attached (in kms) - 4.9 KMS		Yes
	Number of beds registered as per BNH Act – 100 Beds	Yes	
	2) Name of the Hospital : RAINBOW INSTITUTE OF MEDICAL SCIENCE , AMRAVATI	Yes	
	Address: Badnera Rd, beside Neelam Hotel, Rajapeth, Sharda Vihar, Amravati, Maharashtra 444605		
	Telephone No. : 0721-2579199, 0721-2579188		
	Bed Strength : 137 Beds		
	Distance of Hospital from the College to which it is attached (in kms) - 4.9 KMS		Yes
	Number of beds registered as per BNH Act – 137 Beds	Yes	
	3) Name of the Hospital : AROGYAM INSTITUTE OF MEDICAL SCIENCES , AMRAVATI (MURKEY HOSPITAL)	Yes	
	Address: Old Cotton Market, Amravati - 444601, Walcut Compound, Bajaj Nagar		
	Telephone No. : 07212575792,0721257593		
	Bed Strength : 50 Beds		
	Distance of Hospital from the College to which it is attached (in kms) - 7.6 KMS		Yes
	Number of beds registered as per BNH Act – 50 Beds	Yes	
	4) Name of the Hospital : Manas Clinic and Baba De-Addiction Centre	Yes	
	Address: Rukhmini Nagar, Amravati Congress Nagar Road, Amravati		
	Telephone No. : 94221 90700		
	Bed Strength : 62 Beds		
	Distance of Hospital from the College to which it is attached (in kms) - 8.2 kms		Yes
	Number of beds registered as per BNH Act – 62 Beds	Yes	
	5) Name of the Hospital : DISTRICT GENERAL HOSPITAL, AMRAVATI	Yes	
	Address: Khaparde Bagicha, Maltekdi, Amravati, Maharashtra		
	Telephone No. : 0721 266 3339		
	Bed Strength : 379 Beds		
	Distance of Hospital from the College to which it is attached (in kms) – 07 kms		Yes

	Number of beds registered as per BNH Act – 379 Beds	Yes	
	6) Name of the Hospital : DISTRICT HOSPITAL FOR WOMEN, AMRAVATI (Dafferin)	Yes	
	Address: Shrikrishna Peth, Amravati, Maharashtra		
	Telephone No. : <u>0721 266 3339</u>		
	Bed Strength : 205 Beds		
	Distance of Hospital from the College to which it is attached (in kms) – 08 KMS	Yes	
	Number of beds registered as per BNH Act – 205 Beds	Yes	
	7) Name of the Hospital : Superspeciality and Referral Hospital		
	Address: Shrikrishna Peth, Amravati, Maharashtra		
	Telephone No. : <u>098675 98674</u>		
	Bed Strength : 100 Beds		
	Distance of Hospital from the College to which it is attached (in kms) - 8 KMS	Yes	
	Number of beds registered as per BNH Act – 100 Beds	Yes	
7	I. Total constructed area of Hospital Building as per MSR (.....Sq.mtr. / Sq.ft.)	Yes	
	Whether the Hospital is Owned by the College / Management or Rented ?	Yes	
	II. Hospital Administration Block as per MSR (Superintendent room, Deputy Superintendent room, Medical officers' room, Matron room, Assistant Matron room, Reception and Registration, etc.)	Yes	
	III. Out-Patient Departments (OPD) as per MSR Total Area of OPD Complex ... Sq.ft. No. of OPD's Facilities shall be as per MSR & all details shall be on college website.	Yes	
	IV. In Patient Departments (IPD) as per MSR Total Area of IPD Complex ... Sq.ft. No. of IPD Departments..... Bed Distribution..... Facilities shall be as per MSR & all details shall be on college website.	Yes	
	V. Operation Theatres Block as per MSR Total Area of OT Block ... sq.ft. No. of OTs available Facilities shall be as per MSR & all details shall be on college website.	Yes	
	VI. Casualty Facilities State Government Permission Letter	Yes	
	VII. Central Clinical Laboratory: Well-equipped with separate sections for Pathology, Biochemistry and Micro-biology. Attached toilet shall be there for collection of urine samples. Other diagnostic tools for ECG or TMT etc. shall be provided.	Yes	
	VIII. Radiology or Sonography Section: Radiologist chamber, X-ray room, Dark room, film drying room, store room, patients waiting and dressing room, reception or registration or report room.	Yes	
	IX. Labour Room :	Yes	

 Principal
 Dean, Principal Staff & Signature
 Science & Research, Amravati

**SARASWATI INSTITUTE OF NURSING SCIENCES & RESEARCH
AMRAVATI**

Teaching Block

Sr. No	Teaching Block	Institute Area (Figures in Sq feet)
1	Lecture Hall	7@900=6300 sqft
2	i)Nursing foundation lab	1400 sqft
	ii)CHN	600 sqft
	iii)Nutrition	600 sqft
	iv)OBG and Pediatrics lab	750 sqft
	v)Pre-clinical science lab	750 sqft
	vi)Computer lab	700 sqft
3	Multipurpose Hall	2200 sqft
4	Common Room (Male & Female	600 sqft
5	Principal Room	300 sqft
6	Vice Principal Room	200 sqft
7	Library	1800 sqft
8	A.V. Aids Room	400 sqft
9	One room for each Head of Departments	-
10	Faculty Room	1700 sqft
11	Provisions for Toilets	700 sqft
12	Advance skill Lab	1000 sqft
13	Anatomy Lab	400 sqft
Total		20368 Sqft.

Principal
Saraswati Institute of Nursing
Science & Research, Amravati

Hostel Block

Sr. No	Hostel Block	Institute Area (Figures in Sq feet)
1	Single Room	9300 sqft
	Double Room	
2	Sanitary	1854 sqft
3	Visitor Room	500 sqft
4	Reading Room	250 sqft
5	Store Room	500 sqft
6	Recreation Room	500 sqft
7	Dining Room	3000 sqft
8	Kitchen & Store	1500 sqft
9	Chowkidar Room	500 sqft
Total		17904 sqft

Principal
Saraswati Institute of Nursing
Science & Research, Amravati

Disclaimer: AutoCAD is an equal based software tool used by Municipal Corporations but the final approval lies with concerned Officer / Authority

AREA TABLE BEFORE AMALGAMATION										
S.NO	SURFACE AREA	PERCENTAGE AREA	PERCENTAGE AREA	PERCENTAGE AREA	PERCENTAGE AREA	PERCENTAGE AREA	PERCENTAGE AREA	PERCENTAGE AREA	PERCENTAGE AREA	PERCENTAGE AREA
1	10000	100%								

AREA TABLE AFTER AMALGAMATION										
S.NO	AREA	PERCENTAGE AREA	PERCENTAGE AREA	PERCENTAGE AREA	PERCENTAGE AREA	PERCENTAGE AREA	PERCENTAGE AREA	PERCENTAGE AREA	PERCENTAGE AREA	PERCENTAGE AREA
1	10000	100%								

SCALE: 1:500
DATE: / /
PROJECT: /

SCALE: 1:200
DATE: / /
PROJECT: /



AMALGAMATION Triangulation (Scale - 1:500)

Area	10000
Perimeter	10000
Volume	10000
Weight	10000

SEAL OF APPROVAL



OFFICER
MUNICIPAL CORPORATION
AMRAVATI



PLOT AFTER AMALGAMATION (Scale - 1:200)



PLOT BEFORE AMALGAMATION (Scale - 1:200)

PROJECT NO.	
PROJECT NAME	
PROJECT TYPE	
DATE OF APPROVAL	
APPROVED BY	
DATE	

This is a system generated drawing and not for the use of the user. It is not a legal document.

Attested



(Handwritten signature)

Principal
Sarawati Institute of Nursing
Science & Research, Amravati

(Handwritten signature)

Disclaimer: AutoCAD is an input based software tool used by Municipal Corporations but the final approval lies with concerned Officer / Authority.

AREA TABLE BEFORE AMALGAMATION

PLOT	AREA FROM TRIANGULATION DOCUMENT		IMPERVIOUS AREA		DEDUCTIONS (sqm)		NET DEVELOPABLE AREA (sqm)	
	AREA	PERCENTAGE	WATER	WELL	ROAD	DRIVEL	ROAD	DRIVEL
PLOT NO. 18	280.00	100%	0.00	0.00	0.00	0.00	0.00	280.00
PLOT NO. 17	280.00	100%	0.00	0.00	0.00	0.00	0.00	280.00
PLOT NO. 20	280.00	100%	0.00	0.00	0.00	0.00	0.00	280.00
PLOT NO. 23	310.00	100%	0.00	0.00	0.00	0.00	0.00	310.00
TOTAL	1150.00	100%	0.00	0.00	0.00	0.00	0.00	1150.00

AREA TABLE AFTER AMALGAMATION

PLOT	AREA FROM TRIANGULATION DOCUMENT		DEDUCTIONS (sqm)		NET DEVELOPABLE AREA (sqm)	
	AREA	PERCENTAGE	WATER	WELL	ROAD	DRIVEL
PLOT NO. 18	1000.74	100%	0.00	0.00	0.00	0.00
Total	1000.74	100%	0.00	0.00	0.00	1000.74



AMALGAMATION Triangulation (Scale - 1:500)

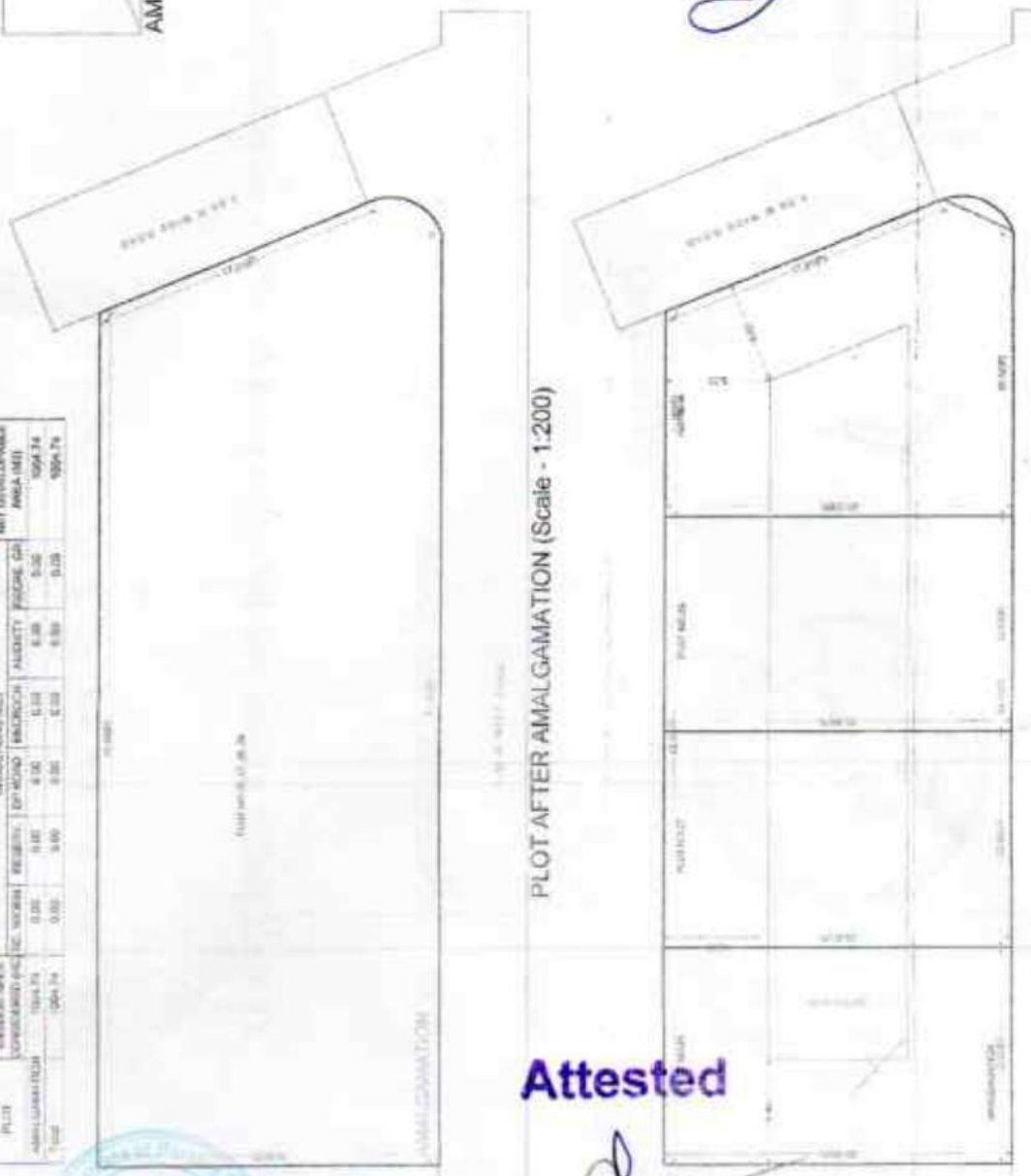

Attested

Sushil
Principal

Saraswati Institute of Nursing Science & Research, Amravati

SEAL OF APPROVAL



अध्यक्ष
शहर नगरपालिका / (क) १६११-११/अमरावती
अ. नगरपालिका / (क) १६११-११/अमरावती
ज्यामिती विभाग / अमरावती
दिनांक: ११/०५/२०२३

डिजाइनर
श्री. संजय शिरोडकर

PROJECT INFORMATION
PLOT NO: 18, 17, 20, 23
VILLAGE: ...
SUBJECT NO: ...

PROJECT TYPE: Amalgamation (Restructure)

CONSULTANT NAME
श्री. संजय शिरोडकर

DATE: 11/05/2023

SCALE: 1:500

PLOT AFTER AMALGAMATION (Scale - 1:200)

PLOT BEFORE AMALGAMATION (Scale - 1:200)

स्वतंत्र पध्दतीचे बांधकाम करतांना.

अ) प्लॉट क्र. २६, २७, २८ व २९ करीता.

१) मंजूर विकास नियंत्रण नियमावलीतील नियम क्र. २६.२+ नुसार समाधिक अंतर अनुज्ञेय राहतील.

(मा. आयुक्त/सत्तेनर हयांच दिनांक 14/12/2017 चे आदेशान्वये मंजूर.)

दिनांक : -----

कार्यालयाचा शिक्का.

Attested



[Handwritten signature]

Principal
Saraswati Institute of Nursing
Science & Research, Amravati

[Handwritten signature]
सहाय्यक संचालक नगर रचना
महानगरपालिका, अमरावती.



Principal
Saraswati Institute of Nursing
Science & Research, Amravati

कार्यालय :- महानगरपालिका अमरावती

जा. क्र. अमनपा/ससनर/उप.प्र./१०४१/२०१८

दिनांक :- २१/०३/२०१८

प्रति,

श्री. संजय शंभरावजी पाटील

रा. अमरावती

विषय :- भुखंड एकत्रिकरणास मंजूरी व आरंभ प्रमाण पत्र / आदेश.

संदर्भ :- १. आपला अजं क्रमांक ०६१७ दिनांक ०५.१२.२०१७

२. -----

महोदय,

उपरोक्त पत्राप्रमाणे आपला अजं घर क्रमांक ----- भुखंड क्रमांक २६, २७, २८ व २९

मौजा-बडनरा सर्व्हे क्र. ३३७/३A मांहल्ला / नगर ----- वाडं क्रमांक -----

----- रस्ता ----- येथील भुखंड विभागणी करीता मंजूरी मिळण्याचे संदर्भात खालील अटीवर मंजूरी आरंभ प्रमाणपत्र देण्यात येत आहे.

१. एकत्रित भुखंडात कोणत्याही प्रकारे बांधकाम अथवा विकास कार्य करण्यापूर्वी महानगरपालिकेची बांधकाम विषयक रितसर परवानगी घ्यावी.
२. भुखंडामध्ये बांधकाम करतांना मुळ एक.एस.आय. १.१ असावा.
३. आरंभ प्रमाणपत्र / आदेश हे परवाना पत्र मिळालेल्या दिवसा पासून एक वर्षा करीता देय राहिल.
४. संलग्न पध्दतीने बांधकाम करतांना दोही एकत्रित भुखंडाचे मालकीची संमती असावयास पाहिजे.
५. भुखंडात कमीत कमी दोन झाडे लावावी.
६. भुखंडामध्ये बांधकाम करतांना खालील प्रमाणे मार्गिनल अंतर सोडावे.
७. प्रकरणातील मालकी हक्काच्या दस्तावेजांमधील नमूद, भुखंडाचे क्षेत्रफळ व या सोबतच नकाशांमध्ये नमूद भुखंडाचे क्षेत्रफळ यामध्ये तफावत असली तरी सोबतच्या नकाशातील क्षेत्रफळ हे मांजमाप व गणीतीय परिगणनेच्या आधारावर असल्याने त्यानुसार भुखंडाचे क्षेत्रफळ अंतिम राहिल.
८. सदर एकत्रित भुखंडावर वार्णज्य वापरान्तये हा वापर बंधनकारक राहिल.

Attested



Principal
Saraswati Institute of Nursing
Science & Research, Amravati

-----२-----

WORK COMPLETION CERTIFICATE

(Byelaw No. 7.4)

TO,

Shir Sanjay S. Patil
Saraswati Institute of Nursing Sciences
& Research, Amravati

Sir,

With reference to your intimation No./Dated 13/3/2013 regarding the completion work up ~~plinth / column upto plinth level / Building~~ completed. Permit No. 1023 Dt-13/10/2010 Survey No. / Sheet No. 337/3A situated at Mouza Badnera Road/ Street _____ Ward No. / Plot No. 27,28,29 I have to inform that the further work may be proceeded with as per sanctioned plan.

Office Communication No. 157
20/3/2013

Office Stamp



Yours faithfully

S. K. Kade
Assistant Director of Town Planning
Badnera, Amravati
The Authority

Attested

Name of Municipal Corporation / Address.

[Signature]
Principal
Saraswati Institute of Nursing
Science & Research, Amravati
Sciences & Research, Amravati



**SARASWATI INSTITUTE OF NURSING SCIENCES & RESEARCH
AMRAVATI**

List of Parents and Affiliated Hospital in Amravati

Sr. No	Name of Hospital	Types Of Hospitals	Sanction Strength	Distances	Type of Experience
1	Hi-tech Multi-Specialty Dr. Bonde Hospital Rajapeth, Amravati	Parent	100	7.4 Km	Multi Specialty
2	Rainbow Institute of Medical Sciences & Research Badnera Road, Amravati	Affiliated	137	4.9 Km	Super Specialty
3	Arogyam Institute of Medical Sciences, Walkat Compound Amravati Dr. Murkey Hospital	Affiliated	50	7.6 Km	Pediatric / GYANE Specialty
4	Manas Clinic & Baba de-addiction Center Rukhmini Nagar, Amravati	Affiliated	62	8.2 Km	Psychiatric Specialty
5	General Hospital Amravati (GOVT)	Affiliated	379	7.6 Km	General (GOVT)
6	District Hospital for women Amravati (GOVT)	Affiliated	205	8 Km	OBGY. GYANE Specialty
7	Super specialty Hospital Amravati (GOVT)	Affiliated	100	8 Km	Multi Specialty
	Total		1012		

Attested



Principal
Saraswati Institute of Nursing
Science & Research, Amravati